

ROUND DOWNSPOUT + ACCESSORIES

ELBOWS ③

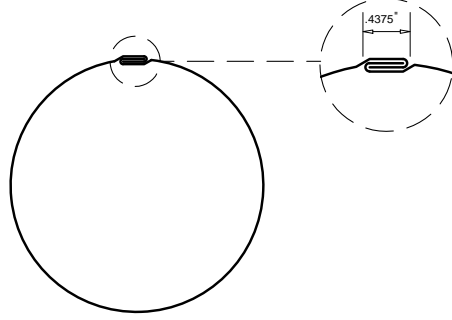

ROUND DOWNSPOUT

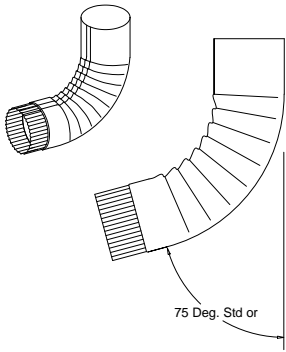
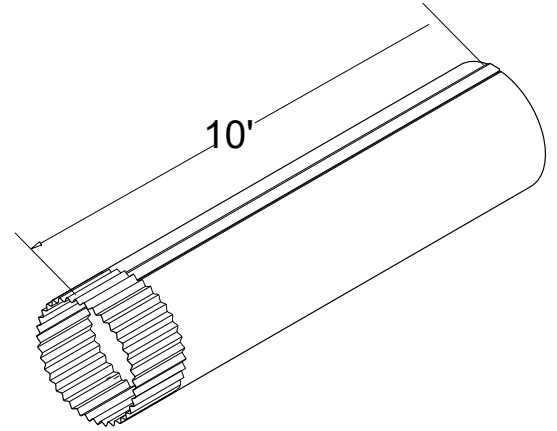

ONE-PIECE OFFSETS ③

"UP" STYLE (EAVE)

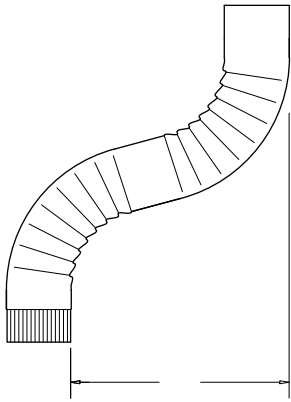

"DOWN" STYLE (LEDGE)

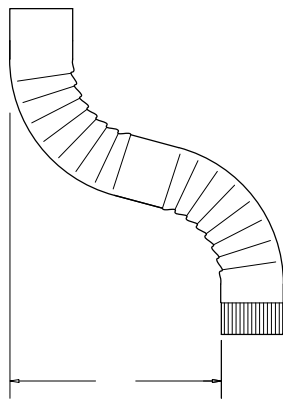

OUTLET TUBES

TYPE A-FLAT TOP

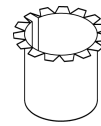

TYPE B-HALF-ROUND TOP

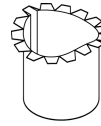

STRAPS

1.625" WIDE WITH .25" HEM

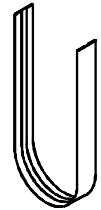

SIZE:

- | | |
|---|--|
| <input type="checkbox"/> 3" ROUND DOWNSPOUT ① | <input type="checkbox"/> 7" ROUND DOWNSPOUT ③ |
| <input type="checkbox"/> 4" ROUND DOWNSPOUT | <input type="checkbox"/> 8" ROUND DOWNSPOUT ③ |
| <input type="checkbox"/> 5" ROUND DOWNSPOUT | <input type="checkbox"/> 9" ROUND DOWNSPOUT ③ |
| <input type="checkbox"/> 6" ROUND DOWNSPOUT | <input type="checkbox"/> 10" ROUND DOWNSPOUT ③ |

NOTES:

- ① Not available in 22ga steel or .050 aluminum.
 ② For products/material not listed, please inquire.
 ③ Elbows and offsets that are 7" and larger will be mitered and caulked.

MATERIAL ②

24GA STEEL
26GA STEEL

.032 ALUMINUM

COLOR:

QUANTITIES:

- ____ LINEAL FEET @ 10'-0" LENGTHS
 ____ OUTLETS STYLE A ____ STYLE B
 ____ ELBOWS (STD. 75°) ③
 ____ ELBOWS (CUSTOM DEGREE) ____ °
 ____ ONE-PIECE OFFSETS ____ " OFFSET AMOUNT ③
 ____ STRAPS (STANDARD = 2 PER 10' DOWNSPOUT)

PRINT APPROVED BY:

(SIGNATURE)

(DATE)

A SIGNED PRINT APPROVAL SIGNIFIES A CUSTOMER HAS VERIFIED ALL DIMENSIONS, SIZES, QUANTITIES, AND MATERIAL TYPES.

FABRICATION WILL PROCEED ONLY AFTER RECEIPT OF SIGNED PRINT APPROVAL



<https://store.gulfcoastsupply.com/> Telephone: 352-498-0778